

# Discover Our New Location!!

## PLACER TOWN & COUNTRY VILLAGE

SEC N. SUNRISE AVENUE & SIERRA GARDENS DRIVE • ROSEVILLE, CA

Just Up The Road  
from the office that has  
been our home for 5 Years

You will LOVE the Beautiful  
setting with its fountains, trees  
and tranquil pathways.

### Directions:

Granite Bay: take Douglas West  
Turn right on Sierra Gardens  
Turn Left in to North Lot

### Bay Area/Sacramento:

Exit I80 at East Douglas  
Turn Left at Sunrise (1<sup>st</sup> Light)  
Turn Right at Sierra Gardens  
Turn Right into the North Lot

### Folsom/Eldorado Hills: Exit I50 Hazel

Take Hazel to Roseville, Turn Left on  
Douglas Blvd. Turn Right on Sierra  
Gardens. Turn Left in to North Lot

Look for the  
BloodSource sign  
& we're right upstairs!

### For Wheelchair

**Access:** Park in south lot  
Under the red State Farm Sign  
and take the elevator to the 2<sup>nd</sup> floor.  
Turn left and follow walkway to #1014

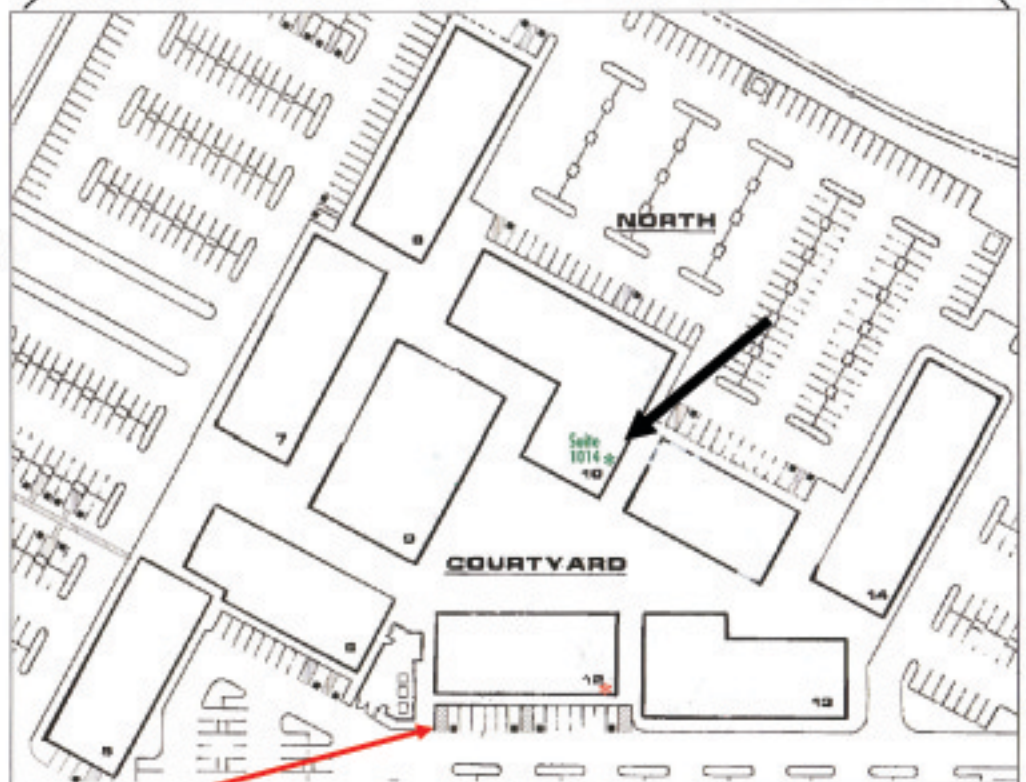
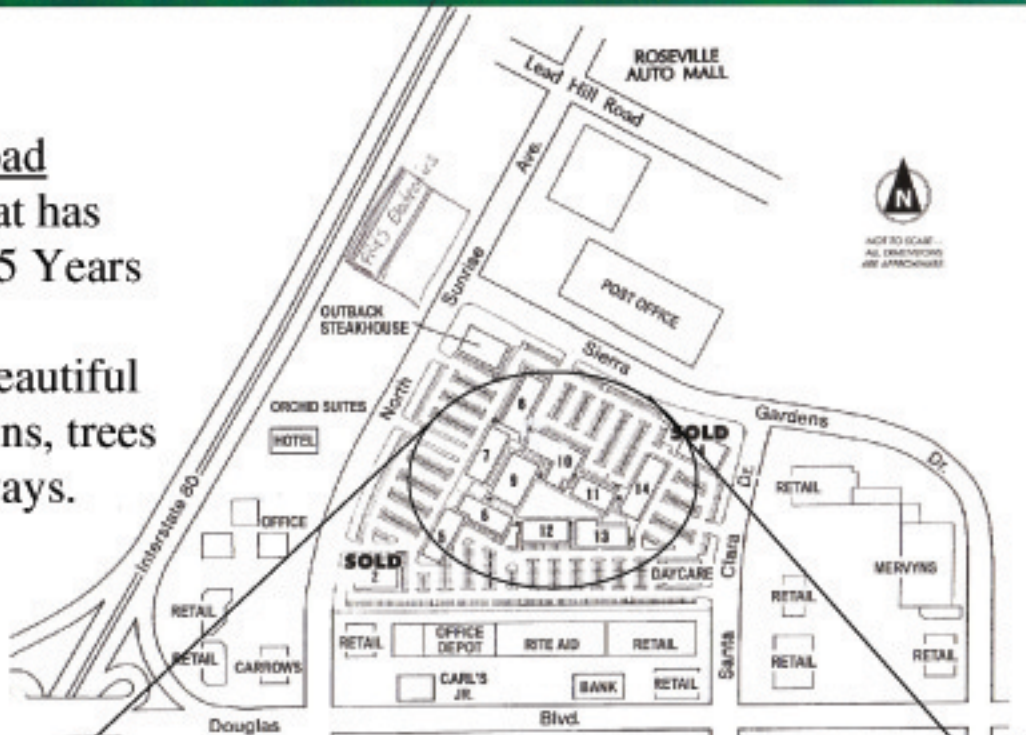

Second Floor